



**VCA Headquarters**  
1 The Eastgate Office Centre  
Eastgate Road  
Bristol, BS5 6XX  
United Kingdom

Switchboard: +44 (0) 117 951 5151  
Main Fax: +44 (0) 117 952 4103  
Email: [enquiries@vca.gov.uk](mailto:enquiries@vca.gov.uk)  
Web: [www.vca.gov.uk](http://www.vca.gov.uk)

---

THE UNITED KINGDOM VEHICLE APPROVAL AUTHORITY

---



COMMUNICATION CONCERNING THE APPROVAL GRANTED OF A TYPE  
OF MECHANICAL COUPLING DEVICE OR COMPONENT, PURSUANT TO  
REGULATION NO 55.01

---

Approval No: 55R-016170

1. Trade name or mark of the device or component: Reese
2. Manufacturer's name for the type of device or component: 38303, Revolution Sidewinder
3. Manufacturer's name and address:  
  
Cequent Performance Products  
47774 Anchor Court West  
Plymouth MI 48170  
USA
4. If applicable, name and address of the manufacturer's representative:  
  
The Fifth Wheel Company Limited  
Holywell Road  
Rhuallt  
Denbighshire  
LL17 0AW  
United Kingdom
5. Alternative supplier's names or trade marks applied to the device or component: Not applicable
6. Name and address of company or body taking responsibility for the conformity of production:  
  
Cequent Performance Products  
2602 College Avenue  
Goshen  
IN 46528  
USA



7. Submitted for approval on: 10 August 2009
8. Technical service responsible for conducting approval tests: Vehicle Certification Agency
9. Brief description:
- 9.1. Type and class of device or component: H-50X
- 9.2. Characteristic values:
- 9.2.1. Primary values:
- D: 12.65 kN                      Dc..... kN                      S: 550 kg  
U: 0.8 tonnes V..... kN
- Alternative values: Not applicable
- D..... kN                      Dc..... kN                      S..... kg  
U.....tonnes                      V..... kN
- 9.3. For Class A mechanical coupling devices or components, including towing brackets: Not applicable
- Vehicle manufacturer's maximum permissible vehicle mass:                      kg
- Distribution of maximum permissible vehicle mass between the axles:
- Vehicle manufacturer's maximum permissible towable trailer mass:                      kg
- Vehicle manufacturer's maximum permissible static vertical load on coupling ball:                      kgf
- Maximum mass of the vehicle, with bodywork, in running order, including coolant, oils, fuel, tools and spare wheel (if supplied) but not including driver: kg
- Loading condition under which the tow ball height of a mechanical coupling device fitted to category M1 vehicles is to be measured -see paragraph 2 of annex 7, appendix 1:
10. Instructions for the attachment of the coupling device or component type to the vehicle and photographs or drawings of the mounting points given by the vehicle manufacturer: Refer to manufacturer's instruction manual
11. Information on the fitting of any special reinforcing brackets or plates or spacing components necessary for the attachment of the coupling device or component: Refer to manufacturer's instruction manual

12. Additional information where the use of the coupling device or component is restricted to special types of vehicles: Not applicable
13. For Class K hook type couplings, details of the drawbar eyes suitable for use with the particular hook type: Not applicable
14. Date of test report: 20 August 2009
15. Number of test report: 38303
16. Approval mark position: Stamped on top surface of pin box
17. Reason(s) for extension of approval: Not applicable
18. Approval GRANTED
19. Place: BRISTOL
20. Date: 26 JANUARY 2010
21. Signature:  A KUBINSKI
22. The list of documents deposited with the Administrative Service which has granted approval is annexed to this communication and may be obtained on request.



**VCA Headquarters**  
1 The Eastgate Office Centre  
Eastgate Road  
Bristol, BS5 6XX  
United Kingdom

Switchboard: +44 (0) 117 951 5151  
Main Fax: +44 (0) 117 952 4103  
Email: [enquiries@vca.gov.uk](mailto:enquiries@vca.gov.uk)  
Web: [www.vca.gov.uk](http://www.vca.gov.uk)

---

THE UNITED KINGDOM VEHICLE APPROVAL AUTHORITY

---

COMMUNICATION CONCERNING THE TYPE-APPROVAL OF A TYPE OF COMPONENT WITH REGARD TO DIRECTIVE 94/20/EEC, AS LAST AMENDED. RELATING TO COMPONENT OF MECHANICAL COUPLING DEVICES FOR MOTOR VEHICLES AND THEIR TRAILERS

---

Type Approval No: e11\*94/20\*6170\*00

Reason for Extension: Not applicable

**SECTION I**

0.1 Make (trade name of manufacturer): Reese

0.2 Type and general commercial description(s): 38303, Revolution Sidewinder

0.3 Means of identification of type if marked on the component: 38303

0.3.1 Location of that marking: Adhesive label

0.5 Name and address of manufacturer:

Cequent Performance Products  
47774 Anchor Court West  
Plymouth MI 48170  
USA

0.7 In the case of components and separate technical units, location and method of affixing of the EEC approval mark: Stamped on top surface of pin box

0.8 Name(s) and address(es) of assembly plants:

Cequent Performance Products  
2602 College Avenue  
Goshen IN 46528  
USA

## SECTION II

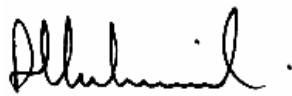
1. Additional information (where applicable): See Appendix I
2. Technical service responsible for carrying out the tests: Vehicle Certification Agency
3. Date of test report: 20 August 2009
4. Number of test report: 38303
5. Remarks (if any): See Appendix I
6. Place: BRISTOL
7. Date: 26 JANUARY 2010
8. Signature:  A KUBINSKI
9. The index to the information package lodged with the competent authority that has granted type approval, which may be obtained on request, is attached.

## APPENDIX I

to EEC type approval certificate No: e11\*94/20\*6170\*00  
concerning the component type-approval of mechanical coupling devices with regard to Directive  
94/20/EC

1. Additional information
  - 1.1 Class of type of coupling: H-50X
  - 1.2 Categories or types of vehicles for which the device is designed or restricted: Refer to manufacturer's instruction manual
  - 1.3 Maximum D-value: 12.65 kN
  - 1.4 Maximum vertical load S at the coupling point: 550 kg
  - 1.5 Maximum load U at the fifth wheel coupling point: 0.8 tonnes
  - 1.6 Maximum V-value: Not applicable
  - 1.7 Instructions for attachment of the coupling type to the vehicle and photographs or drawings of the fixing points at the vehicle given by the manufacturer; additional information if the use of the coupling type is restricted to special types of vehicles: Refer to manufacturer's instruction manual
  - 1.8 Information on the fitting of special towing brackets or mounting plates: Refer to manufacturer's instruction manual
5. Remarks: Unsuitable for positive steering



**VCA Headquarters**  
1 The Eastgate Office Centre  
Eastgate Road  
Bristol, BS5 6XX  
United Kingdom

Switchboard: +44 (0) 117 951 5151  
Main Fax: +44 (0) 117 952 4103  
Email: [enquiries@vca.gov.uk](mailto:enquiries@vca.gov.uk)  
Web: [www.vca.gov.uk](http://www.vca.gov.uk)

Approval number: e11\*94/20\*6170\*00

## INFORMATION PACKAGE CONTENTS

### INDEX

REVISION NUMBER: Not applicable

Total number of sheets: 10

Number of separate drawings: 0

Number of separate photographs: 0

Revision date

&

Office stamp

USK205661

An executive agency of the Department for Transport  
June 2008 Issue 1



# **APPROVAL APPLICATION DOCUMENT**

**TITLE:** Mechanical Coupling Devices  
94/20/EEC and ECE 55-01

**MANUFACTURER:** Cequent Performance Products  
47774 Anchor Court West  
Plymouth  
MI 48170  
USA

**COMPONENT:** Fifth Wheel Coupling Pin  
Class H50-X

**REASON FOR APPLICATION:**  
New approval.

<b>APPROVAL NO:</b> NEW	<b>JOB NO:</b> VCA – USK205661
<b>APPROVAL NO:</b> NEW	<b>TEST DATE:</b> October / November 2009
<b>COMPLETION DATE:</b> November 2009	<b>PAGE:</b> 1 of 10, Title Page

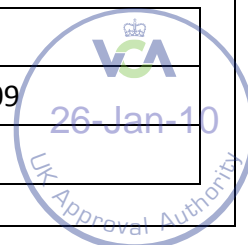



## INDEX

Page 3: General.

Page 4: Connections between drawing vehicles and semi-trailers

Page 5: Drawing – Exploded view of ‘38303 Revolution Sidewinder’ pin box

Page 6: Drawing - Dimensioned side view of ‘38303 Revolution Sidewinder’ pin box

Page 7: Drawing - Dimensioned front view of ‘38303 Revolution Sidewinder’ pin box

Page 8: Drawing – Pin box / trailer frame interface & weld location

Page 9: Drawing – Dimensioned view of coupling pin

Page 10: Drawing – location of approval marking

<b>APPROVAL NO:</b> NEW	<b>JOB NO:</b> VCA – USK205661
<b>APPROVAL NO:</b> NEW	<b>TEST DATE:</b> October / November 2009
<b>COMPLETION DATE:</b> November 2009	<b>PAGE:</b> 2 of 10, Index



**0. GENERAL**

0.1 Make (trade name of manufacturer): Reese.

0.2 Type and general commercial description: 38303, Revolution Sidewinder.

0.3 Name and address of manufacturer: Cequent Performance Products  
47774 Anchor Court West  
Plymouth  
MI 48170  
USA

0.7 In the case of components and separate technical units, location and method of affixing of the EEC type approval mark: See page 10.

0.8 Address of assembly plant: Cequent Performance Products  
2602 College Avenue  
Goshen  
IN 46528  
USA

0.9 Name and address of manufacturer's representative: The Fifth Wheel Company Limited  
Holywell Road  
Rhualt  
Denbighshire  
LL17 0AW  
United Kindom

<b>APPROVAL NO:</b> NEW	<b>JOB NO:</b> VCA – USK205661
<b>APPROVAL NO:</b> NEW	<b>TEST DATE:</b> October / November 2009
<b>COMPLETION DATE:</b> November 2009	<b>PAGE:</b> 3 of 10

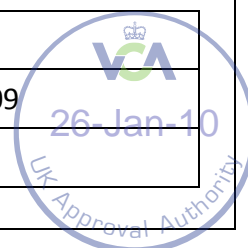

**1. CONNECTIONS BETWEEN DRAWING VEHICLES AND TRAILERS AND SEMI-TRAILERS**

- 1.1 Detailed technical description (including drawings and material specifications):
- 1.2 Class and type of the coupling device(s): H50-X, fifth wheel coupling pin.
- 1.3 Maximum D-value: 12.65 kN.
- 1.4 Maximum vertical load S at the coupling point: 550 kg.
- 1.5 Maximum load U at the fifth wheel coupling: 0.8 tonnes.
- 1.6 Maximum V-value: Not applicable.
- 1.7 Instructions for the attachment of the coupling type to the vehicle and photographs or drawings of the fixing points at the vehicle given by the manufacturer; additional information if the use of the coupling type is restricted to special types of vehicles: Refer to manufacturer's instruction manual.

<b>APPROVAL NO:</b> NEW	<b>JOB NO:</b> VCA – USK205661
<b>APPROVAL NO:</b> NEW	<b>TEST DATE:</b> October / November 2009
<b>COMPLETION DATE:</b> November 2009	<b>PAGE:</b> 4 of 10



## DETAILED TECHNICAL DESCRIPTION

Drawing: Exploded view of '38303 Revolution Sidewinder' pin box

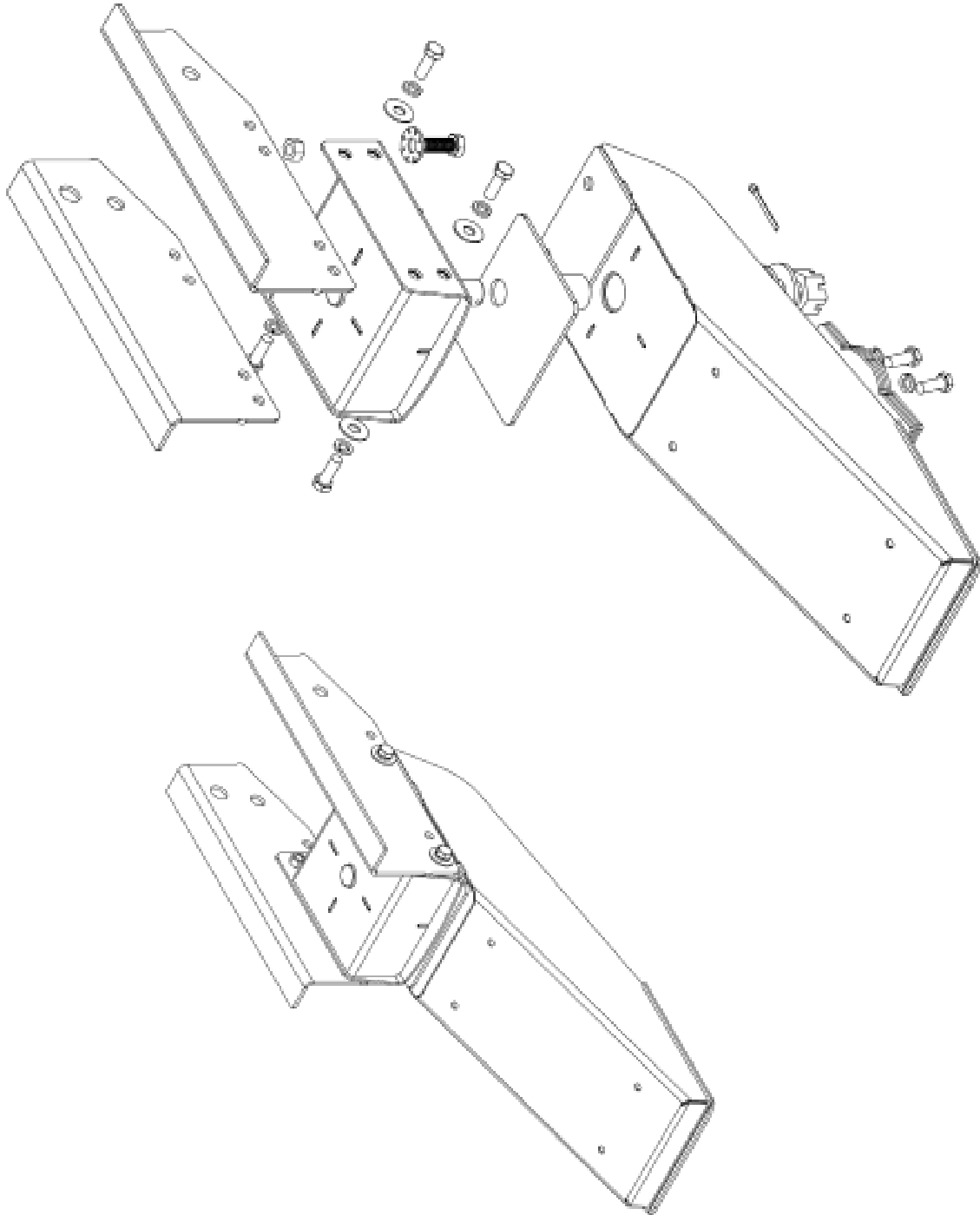

<b>APPROVAL NO:</b> NEW	<b>JOB NO:</b> VCA – USK205661
<b>APPROVAL NO:</b> NEW	<b>TEST DATE:</b> October / November 2009
<b>COMPLETION DATE:</b> November 2009	<b>PAGE:</b> 5 of 10

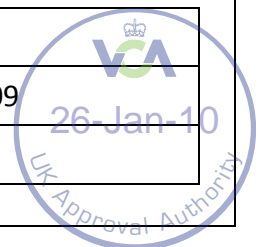

DETAILED TECHNICAL DESCRIPTION

Drawing: Dimensioned side view of '38303 Revolution Sidewinder' pin box

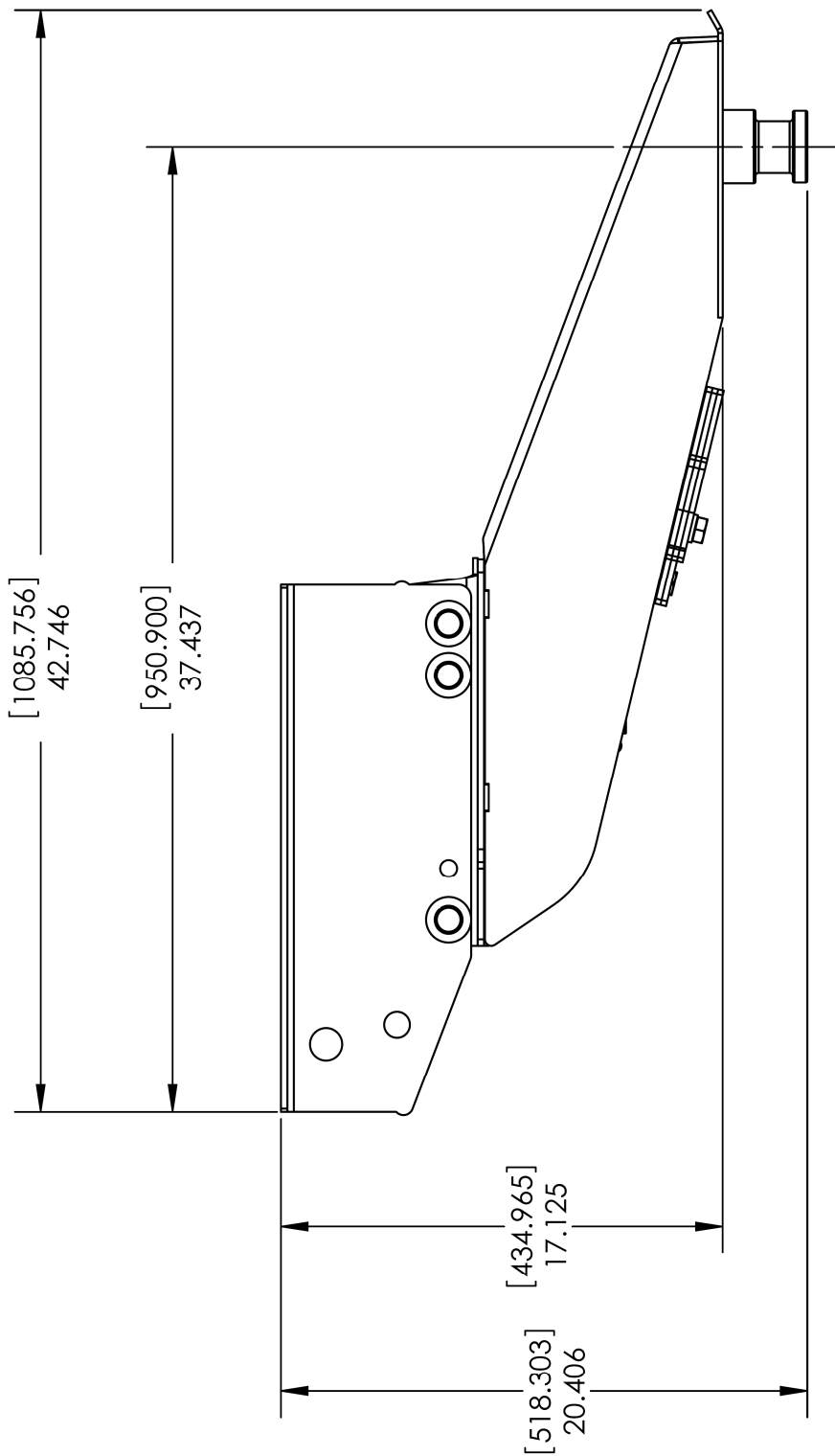

APPROVAL NO: NEW	JOB NO: VCA – USK205661
APPROVAL NO: NEW	TEST DATE: October / November 2009
COMPLETION DATE: November 2009	PAGE: 6 of 10

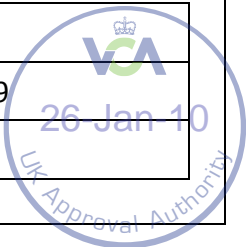

DETAILED TECHNICAL DESCRIPTION

Drawing: Dimensioned front view of '38303 Revolution Sidewinder' pin box

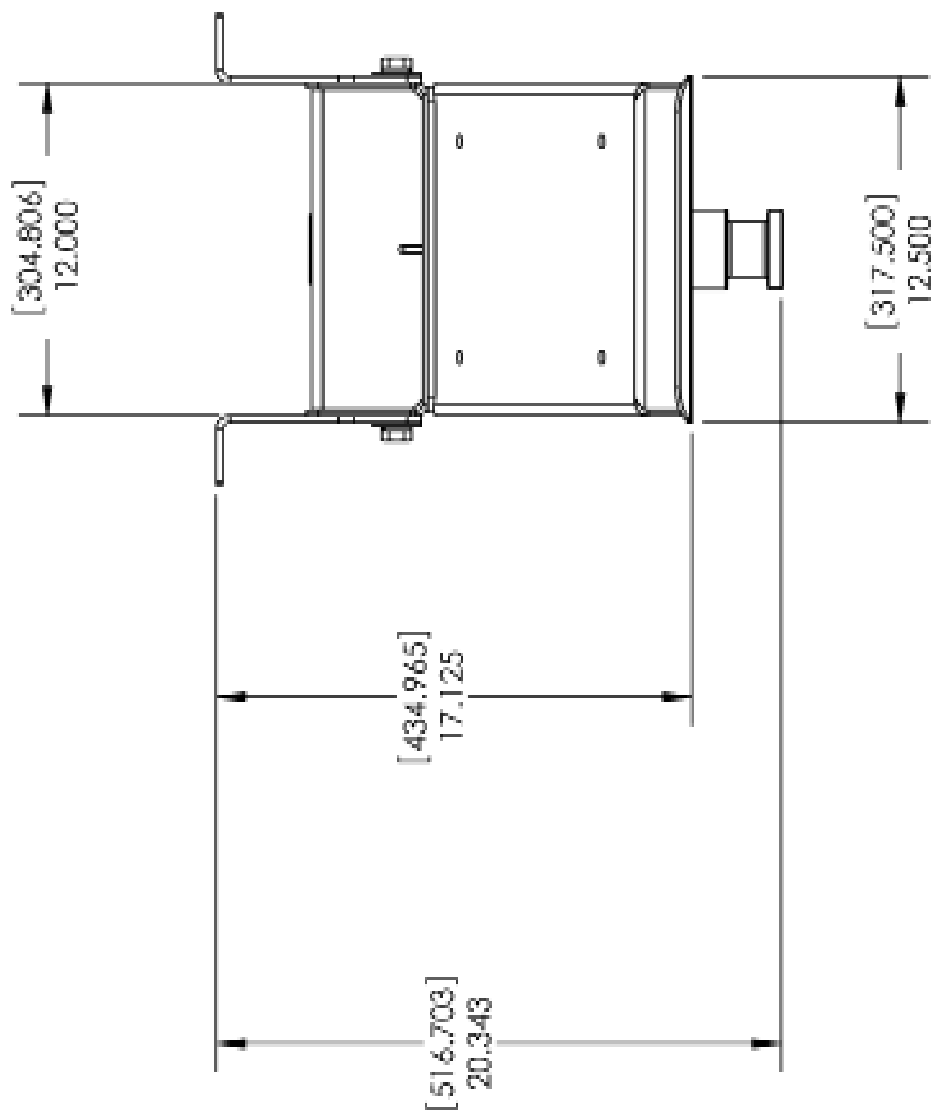

APPROVAL NO: NEW	JOB NO: VCA – USK205661
APPROVAL NO: NEW	TEST DATE: October / November 2009
COMPLETION DATE: November 2009	PAGE: 7 of 10

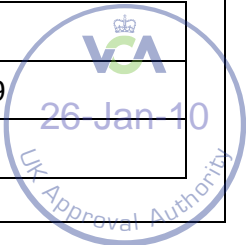

DETAILED TECHNICAL DESCRIPTION

Drawing: Pin box / trailer frame interface & weld location

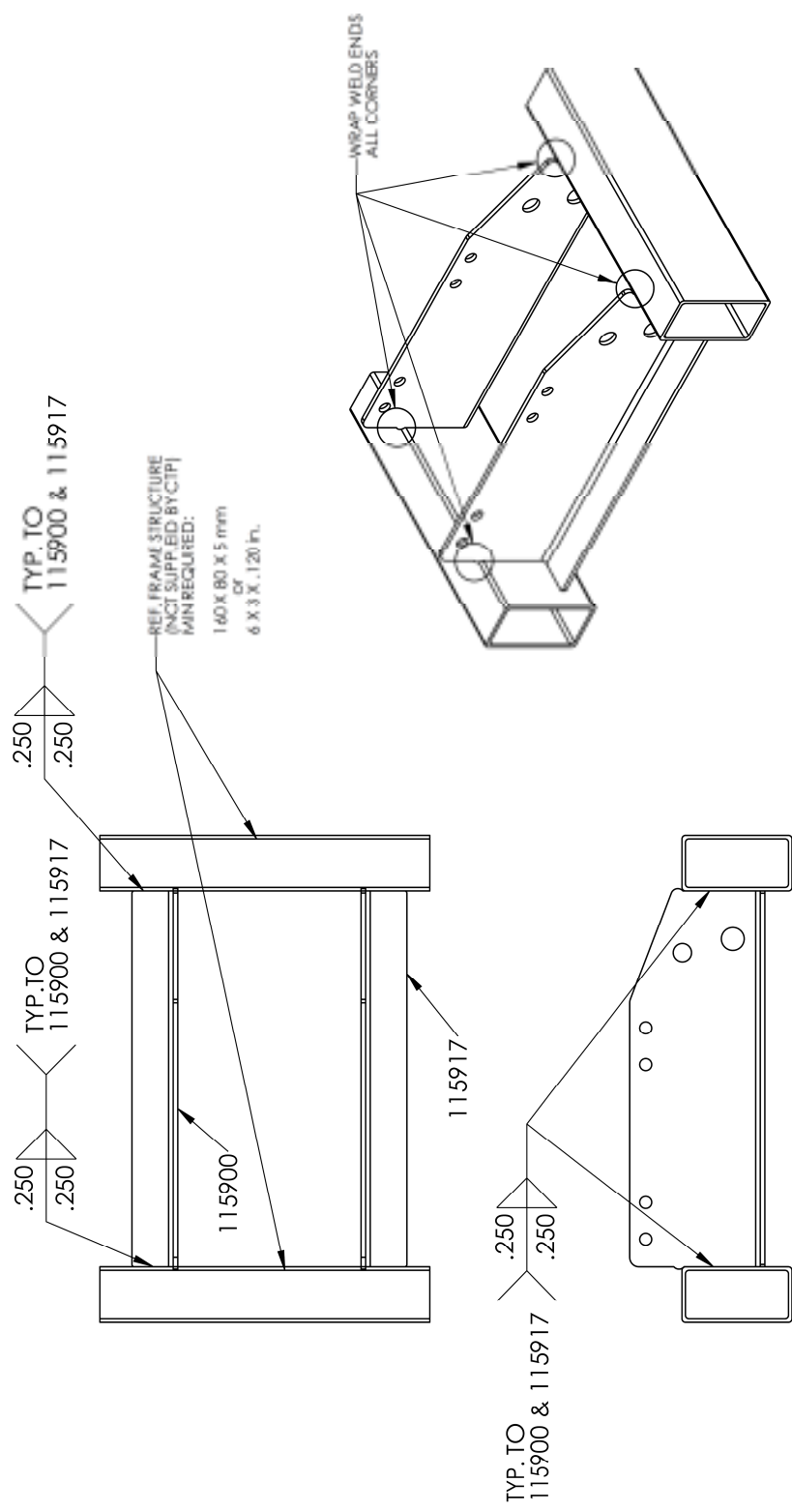

APPROVAL NO: NEW	JOB NO: VCA – USK205661
APPROVAL NO: NEW	TEST DATE: October / November 2009
COMPLETION DATE: November 2009	PAGE: 8 of 10



## DETAILED TECHNICAL DESCRIPTION

Drawing: Dimensioned view of coupling pin (dimensions in [mm])

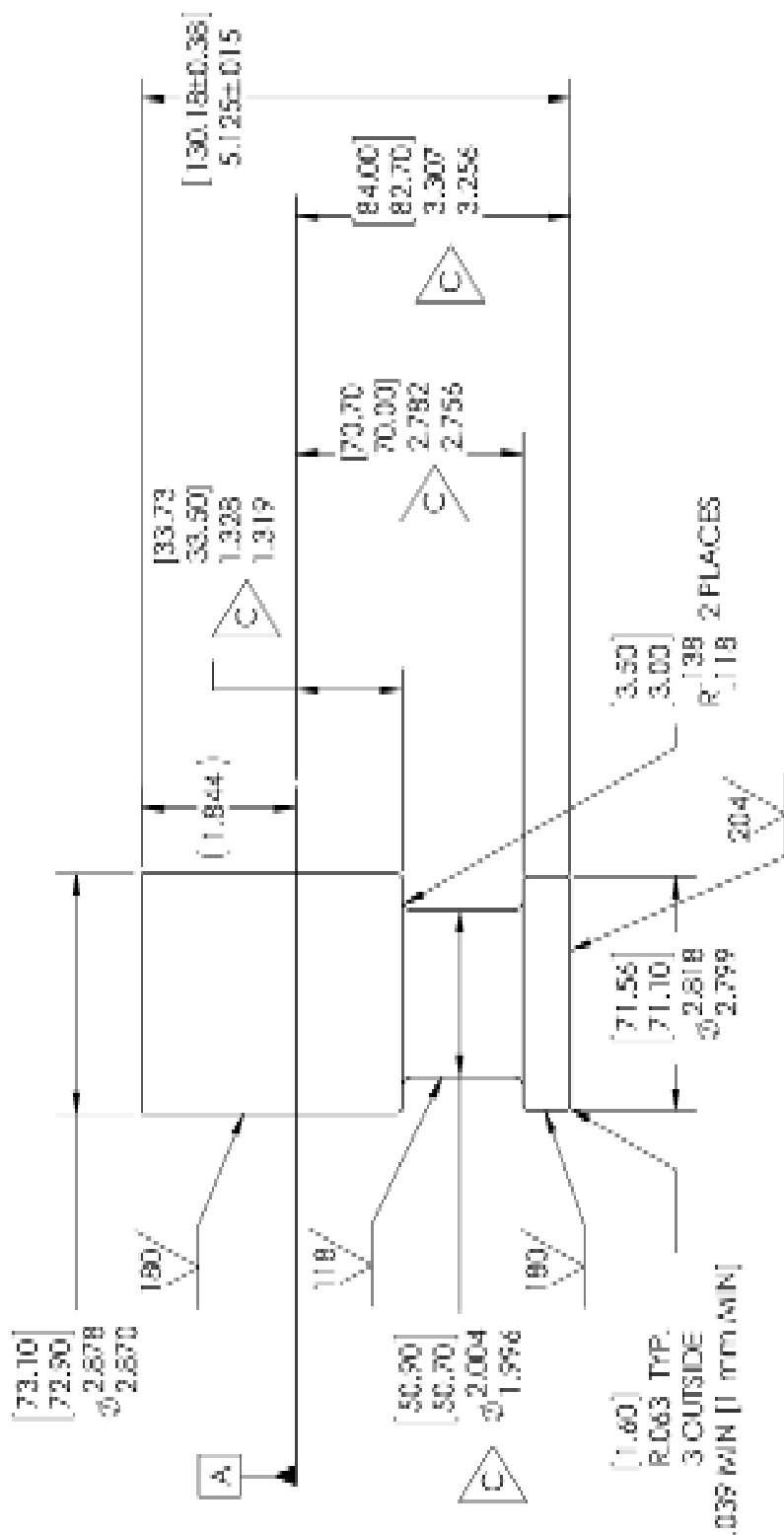

APPROVAL NO: NEW	JOB NO: VCA – USK205661
APPROVAL NO: NEW	TEST DATE: October / November 2009
COMPLETION DATE: November 2009	PAGE: 9 of 10

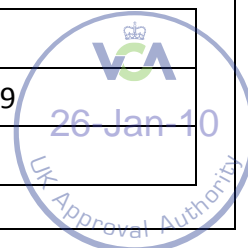



DETAILED TECHNICAL DESCRIPTION

Drawing: Location of approval marking

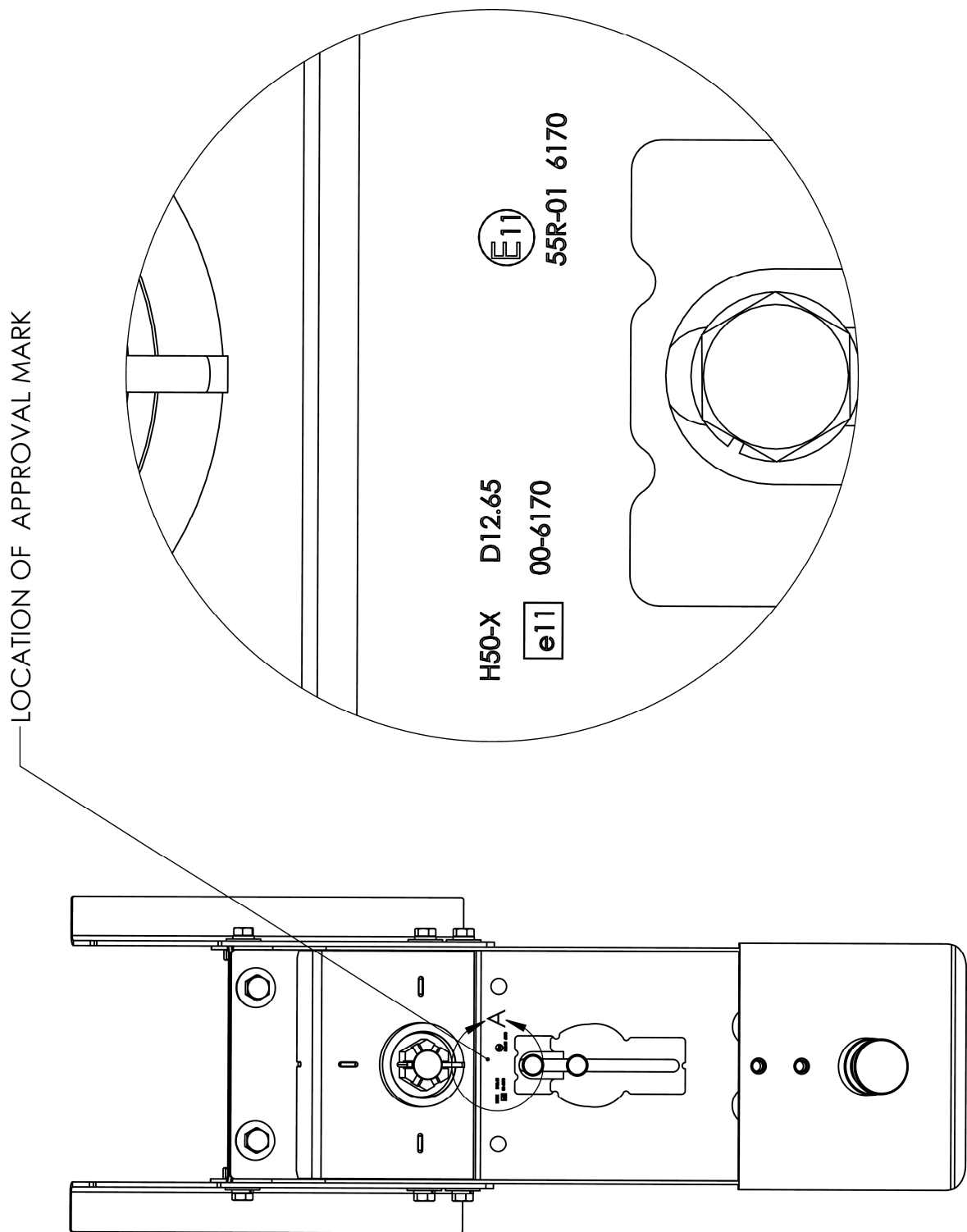

APPROVAL NO: NEW	JOB NO: VCA – USK205661
APPROVAL NO: NEW	TEST DATE: October / November 2009
COMPLETION DATE: November 2009	PAGE: 10 of 10

